

# NEAT

elegant and compact round recessed downlight range for lower output applications

## DESIGN

### WACO

#### DESCRIPTION

Compact ceiling recessed downlight made of steel and aluminium. Powder coated in either structural white or black paint. Neat is designed to personalise with accessories such as an anti-glare baffle, a softening patterned glass or a honeycomb louvre. The setup of the product allows an easy integration and even a combination of these accessories.

#### LED DATA

Cree COB modules integrated, ensuring a great performance and high system efficacy.

## RANGE

The Neat range comes in a fixed version and a directional version, in the same design and format so that both can be perfectly combined in one installation. Various versions are available: 1000lm and 1800lm in 2700, 3000 and 4000K, both CRI80+ and CRI90+, both with either a fixed output driver or a DALI driver.

#### POWER SUPPLY

230V (LED driver included)

#### INSTALLATION

Ceiling recessed by means of torsion springs.

# NEAT DIRECTIONAL

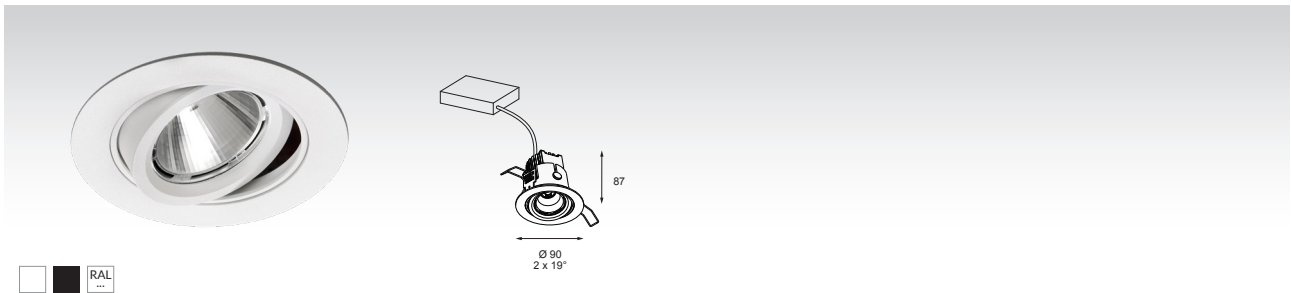

1000lm	W (system)	Lumens (system)	CRI	CCT	White structure	Black structure
spot 15°	8W	930lm	>80	2700K	370.02.RA.09.1	370.02.RA.17.1
	8W	980lm	>80	3000K	370.02.RB.09.1	370.02.RB.17.1
	8W	1060lm	>80	4000K	370.02.RC.09.1	370.02.RC.17.1
medium 35°	8W	920lm	>80	2700K	370.02.RA.09.2	370.02.RA.17.2
	8W	970lm	>80	3000K	370.02.RB.09.2	370.02.RB.17.2
	8W	1050lm	>80	4000K	370.02.RC.09.2	370.02.RC.17.2
flood 50°	8W	910lm	>80	2700K	370.02.RA.09.3	370.02.RA.17.3
	8W	960lm	>80	3000K	370.02.RB.09.3	370.02.RB.17.3
	8W	1040lm	>80	4000K	370.02.RC.09.3	370.02.RC.17.3

1000lm	W (system)	Lumens (system)	CRI	CCT	White structure	Black structure
spot 15°	10W	850lm	>90	2700K	370.02.RD.09.1	370.02.RD.17.1
	10W	900lm	>90	3200K BBBL	370.02.BE.09.1	370.02.BE.17.1
	10W	950lm	>90	4000K	370.02.RF.09.1	370.02.RF.17.1
medium 35°	10W	840lm	>90	2700K	370.02.RD.09.2	370.02.RD.17.2
	10W	890lm	>90	3200K BBBL	370.02.BE.09.2	370.02.BE.17.2
	10W	940lm	>90	4000K	370.02.RF.09.2	370.02.RF.17.2
flood 50°	10W	830lm	>90	2700K	370.02.RD.09.3	370.02.RD.17.3
	10W	880lm	>90	3200K BBBL	370.02.BE.09.3	370.02.BE.17.3
	10W	930lm	>90	4000K	370.02.RF.09.3	370.02.RF.17.3

1000lm DALI	W (system)	Lumens (system)	CRI	CCT	White structure	Black structure
spot 15°	8W	930lm	>80	2700K	370.02.RA.09.1.DALI	370.02.RA.17.1.DALI
	8W	980lm	>80	3000K	370.02.RB.09.1.DALI	370.02.RB.17.1.DALI
	8W	1060lm	>80	4000K	370.02.RC.09.1.DALI	370.02.RC.17.1.DALI
medium 35°	8W	920lm	>80	2700K	370.02.RA.09.2.DALI	370.02.RA.17.2.DALI
	8W	970lm	>80	3000K	370.02.RB.09.2.DALI	370.02.RB.17.2.DALI
	8W	1050lm	>80	4000K	370.02.RC.09.2.DALI	370.02.RC.17.2.DALI
flood 50°	8W	910lm	>80	2700K	370.02.RA.09.3.DALI	370.02.RA.17.3.DALI
	8W	960lm	>80	3000K	370.02.RB.09.3.DALI	370.02.RB.17.3.DALI
	8W	1040lm	>80	4000K	370.02.RC.09.3.DALI	370.02.RC.17.3.DALI

1000lm DALI	W (system)	Lumens (system)	CRI	CCT	White structure	Black structure
spot 15°	10W	850lm	>90	2700K	370.02.RD.09.1.DALI	370.02.RD.17.1.DALI
	10W	900lm	>90	3200K BBBL	370.02.BE.09.1.DALI	370.02.BE.17.1.DALI
	10W	950lm	>90	4000K	370.02.RF.09.1.DALI	370.02.RF.17.1.DALI
medium 35°	10W	840lm	>90	2700K	370.02.RD.09.2.DALI	370.02.RD.17.2.DALI
	10W	890lm	>90	3200K BBBL	370.02.BE.09.2.DALI	370.02.BE.17.2.DALI
	10W	940lm	>90	4000K	370.02.RF.09.2.DALI	370.02.RF.17.2.DALI
flood 50°	10W	830lm	>90	2700K	370.02.RD.09.3.DALI	370.02.RD.17.3.DALI
	10W	880lm	>90	3200K BBBL	370.02.BE.09.3.DALI	370.02.BE.17.3.DALI
	10W	930lm	>90	4000K	370.02.RF.09.3.DALI	370.02.RF.17.3.DALI

Photometric tests have been performed without accessories (baffle, glass and honeycomb).

Weight	Light source	Driver	Ceiling cutout	Ceiling thickness
0,44Kg	LED included	LED driver included	Ø 82mm	1 - 25mm



# NEAT DIRECTIONAL

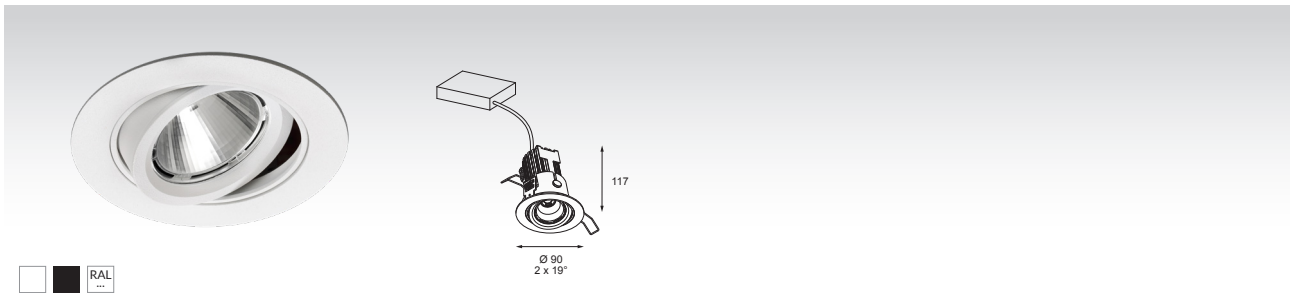

1800lm	W (system)	Lumens (system)	CRI	CCT	White structure	Black structure
spot 15°	17W	1610lm	>80	2700K	370.02.RG.09.1	370.02.RG.17.1
	17W	1710lm	>80	3000K	370.02.RH.09.1	370.02.RH.17.1
	17W	1840lm	>80	4000K	370.02.RI.09.1	370.02.RI.17.1
medium 35°	17W	1590lm	>80	2700K	370.02.RG.09.2	370.02.RG.17.2
	17W	1690lm	>80	3000K	370.02.RH.09.2	370.02.RH.17.2
	17W	1820lm	>80	4000K	370.02.RI.09.2	370.02.RI.17.2
flood 50°	17W	1570lm	>80	2700K	370.02.RG.09.3	370.02.RG.17.3
	17W	1670lm	>80	3000K	370.02.RH.09.3	370.02.RH.17.3
	17W	1800lm	>80	4000K	370.02.RI.09.3	370.02.RI.17.3

1800lm	W (system)	Lumens (system)	CRI	CCT	White structure	Black structure
spot 15°	20W	1470lm	>90	2700K	370.02.RJ.09.1	370.02.RJ.17.1
	20W	1530lm	>90	3200K BBBL	370.02.BK.09.1	370.02.BK.17.1
	20W	1630lm	>90	4000K	370.02.RL.09.1	370.02.RL.17.1
medium 35°	20W	1450lm	>90	2700K	370.02.RJ.09.2	370.02.RJ.17.2
	20W	1530lm	>90	3200K BBBL	370.02.BK.09.2	370.02.BK.17.2
	20W	1600lm	>90	4000K	370.02.RL.09.2	370.02.RL.17.2
flood 50°	20W	1430lm	>90	2700K	370.02.RJ.09.3	370.02.RJ.17.3
	20W	1490lm	>90	3200K BBBL	370.02.BK.09.3	370.02.BK.17.3
	20W	1710lm	>90	4000K	370.02.RL.09.3	370.02.RL.17.3

1800lm DALI	W (system)	Lumens (system)	CRI	CCT	White structure	Black structure
spot 15°	17W	1610lm	>80	2700K	370.02.RG.09.1.DALI	370.02.RG.17.1.DALI
	17W	1710lm	>80	3000K	370.02.RH.09.1.DALI	370.02.RH.17.1.DALI
	17W	1840lm	>80	4000K	370.02.RI.09.1.DALI	370.02.RI.17.1.DALI
medium 35°	17W	1590lm	>80	2700K	370.02.RG.09.2.DALI	370.02.RG.17.2.DALI
	17W	1690lm	>80	3000K	370.02.RH.09.2.DALI	370.02.RH.17.2.DALI
	17W	1820lm	>80	4000K	370.02.RI.09.2.DALI	370.02.RI.17.2.DALI
flood 50°	17W	1570lm	>80	2700K	370.02.RG.09.3.DALI	370.02.RG.17.3.DALI
	17W	1670lm	>80	3000K	370.02.RH.09.3.DALI	370.02.RH.17.3.DALI
	17W	1800lm	>80	4000K	370.02.RI.09.3.DALI	370.02.RI.17.3.DALI

1800lm DALI	W (system)	Lumens (system)	CRI	CCT	White structure	Black structure
spot 15°	20W	1470lm	>90	2700K	370.02.RJ.09.1.DALI	370.02.RJ.17.1.DALI
	20W	1530lm	>90	3200K BBBL	370.02.BK.09.1.DALI	370.02.BK.17.1.DALI
	20W	1630lm	>90	4000K	370.02.RL.09.1.DALI	370.02.RL.17.1.DALI
medium 35°	20W	1450lm	>90	2700K	370.02.RJ.09.2.DALI	370.02.RJ.17.2.DALI
	20W	1530lm	>90	3200K BBBL	370.02.BK.09.2.DALI	370.02.BK.17.2.DALI
	20W	1600lm	>90	4000K	370.02.RL.09.2.DALI	370.02.RL.17.2.DALI
flood 50°	20W	1430lm	>90	2700K	370.02.RJ.09.3.DALI	370.02.RJ.17.3.DALI
	20W	1490lm	>90	3200K BBBL	370.02.BK.09.3.DALI	370.02.BK.17.3.DALI
	20W	1710lm	>90	4000K	370.02.RL.09.3.DALI	370.02.RL.17.3.DALI

Photometric tests have been performed without accessories (baffle, glass and honeycomb).

Weight	Light source	Driver	Ceiling cutout	Ceiling thickness
0.52Kg	LED included	LED driver included	Ø 82mm	1 - 25mm



## NEAT ACCESSORIES



Description	Order code
honeycomb louvre	370.00.1.17.0
patterned glass	370.00.2.00.0
white baffle	370.00.3.09.0
black baffle	370.00.3.17.0
custom RAL colour baffle	code upon request